

Sur
LAMER

 MERAAS

Experience a Privileged Location

Sur La Mer benefits from excellent connectivity to popular locations in the city while being located in one of the most-sought-after districts: Jumeirah 1. The community can be reached by road and sea, meaning residents can take in the spectacular coastline at their leisure.

- 5 min - La Mer by Meraas
- 10 mins - City Walk by Meraas
- 15 min - Dubai International Airport
- 45 min - Al Maktoum International Airport





Be Enchanted by La Mer

There are very few places in Dubai that can compare to La Mer. With pristine beaches, lively pavilions and walkways, the destination peaks intrigue in all those who visit. With a variety of dining, leisure, entertainment and shopping options, anything you desire is around the corner from your new home in **Sur La Mer**.

The Magnetism of Port de La Mer

Sur La Mer is located adjacent to Port de La Mer, a ground-breaking master community located at the tip of the peninsula. Residents have access to unparalleled shopping, dining and hospitality experiences, along with leisure, entertainment and convenience options.

- +190 berth marina and yacht club
- Seaside and marina promenades
- Private beach access
- Boutiques, restaurants and cafes
- 4-star and 5-star resorts







Introducing

Sur
LaMER

Seafront Living Redefined

Nestled between the **La Mer** beachfront, the Mediterranean inspired **Port de La Mer** and the azure waters of the Arabian Gulf, **Sur La Mer** will be the first freehold townhouse community located one of Dubai's most prestigious districts, Jumeirah 1.

Inspiration from Italian Architectural Heritage

The charm and majesty of contemporary classic Italian architecture shines through at **Sur La Mer**.

The vibrant material and colour palettes emphasise luxury, distinguishing each villas individuality.

The alluring views of the sea and skyline add a unique character, complementing the overall concept of the community. This exclusive address offers 3, 4 and 5-bedroom townhouses, with rich facades and meticulously planned details, that will appeal to your finer tastes. This is where serenity and class meet a cosmopolitan lifestyle.





European Charm and Coastal Appeal

In a landscape comprising of open spaces shaded by olive and lemon trees, to alleys covered in magenta Bougainville flowers, one truly gets a sense of a European seaside atmosphere.

A linear park along with a host of other world-class amenities complete the experience of living at **Sur La Mer**.















PREMIUM AMENITIES:

- Clubhouse
- Swimming pool and kids pool
- Bicycle sharing
- Electric vehicle charging
- Kids play area
- Shaded seating areas
- 1 km promenade along the water edge
- Private beach access
- Marina access

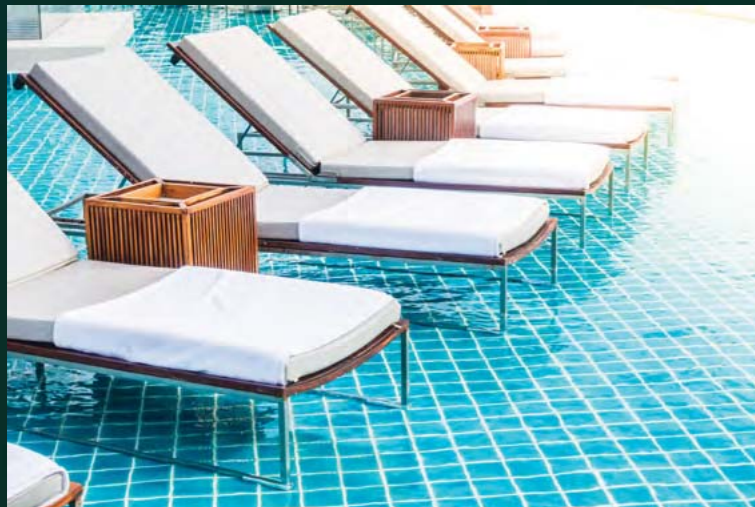

LEGEND:

C LA COTE	1 PDLM BEACH	5 LAGUNA WATER PARK
R LA RIVE	2 PDLM MARINA	6 LA MER BEACH
H HOTELS	3 YACHT CLUB	7 RESTAURANTS & RETAIL
▲ LA MER & PDLM ENTRIES	4 SUR LA MER	8 DUBAI MARINE RESORT
▲ BEACH ACCESS		



Sur
*L*AMER

FLOOR PLANS

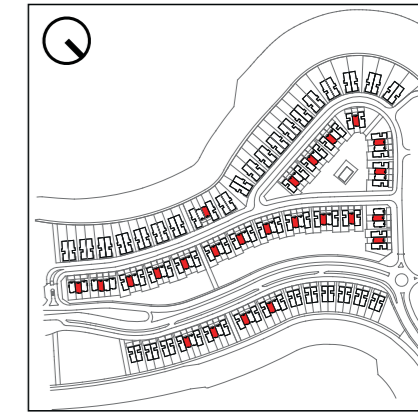
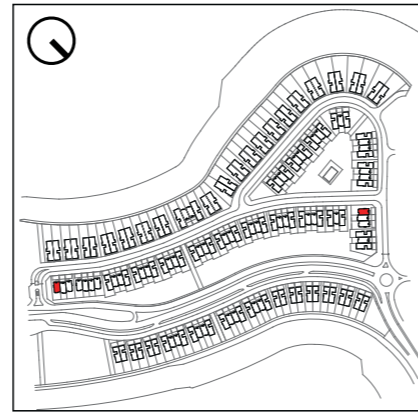

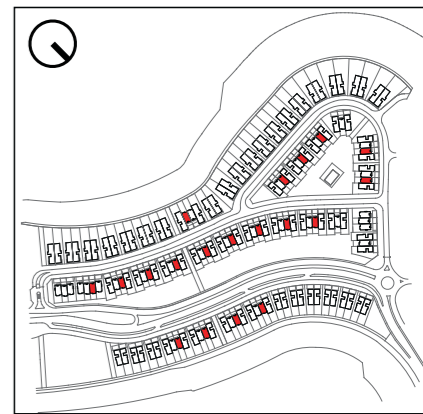
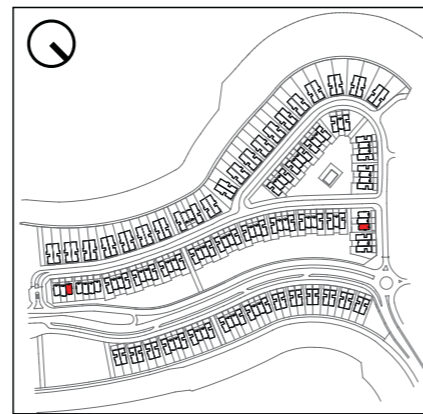

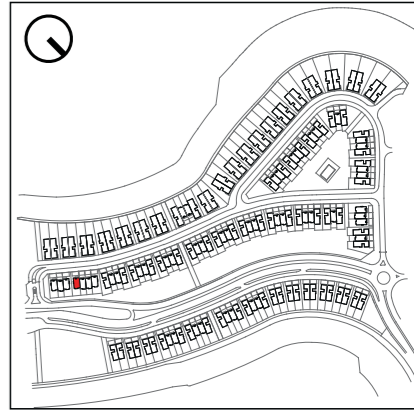
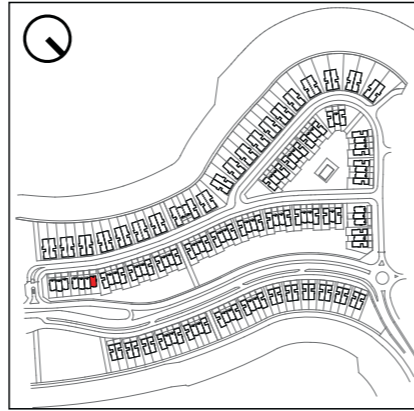

G. FLOOR

1. FLOOR

2. FLOOR

ROOF

3 BEDROOM (TYPE E)
+ FAMILY ROOM/ E

TOTAL AREA
347 sqm | 3,744 sqft



G. FLOOR

1. FLOOR

2. FLOOR

ROOF

3 BEDROOM (TYPE F)
+ FAMILY ROOM/ E

TOTAL AREA
358 sqm | 3,859 sqft

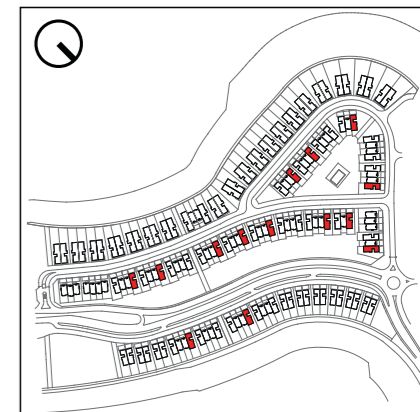

G. FLOOR



1. FLOOR



2. FLOOR



ROOF

4 BEDROOM (TYPE A)
+ FAMILY ROOM/ E

TOTAL AREA
445 sqm | 4,795 sqft



G. FLOOR



1. FLOOR



2. FLOOR



ROOF

4 BEDROOM (TYPE B)
+ FAMILY ROOM/ E

TOTAL AREA
445 sqm | 4,795 sqft



G. FLOOR

1. FLOOR

2. FLOOR

ROOF

4 BEDROOM (TYPE C)
+ FAMILY ROOM/ E

TOTAL AREA
445 sqm | 4,794 sqft



G. FLOOR

1. FLOOR

2. FLOOR

ROOF

4 BEDROOM (TYPE D)
+ FAMILY ROOM/ E

TOTAL AREA
445 sqm | 4,795 sqft

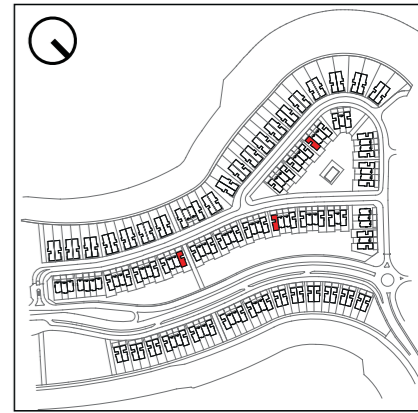

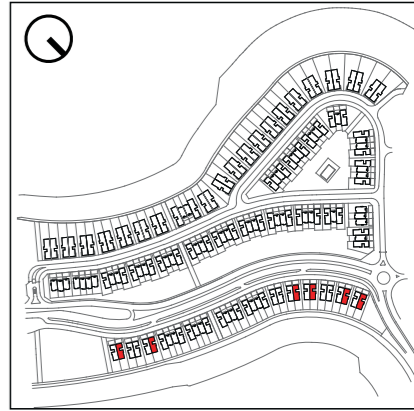

G. FLOOR



1. FLOOR



2. FLOOR



ROOF

4 BEDROOM (TYPE E)
+ FAMILY ROOM/ E

TOTAL AREA
445 sqm | 4,795 sqft



G. FLOOR



1. FLOOR



2. FLOOR



ROOF

4 BEDROOM (TYPE F)
+ FAMILY ROOM/ E

TOTAL AREA
453 sqm | 4,885 sqft

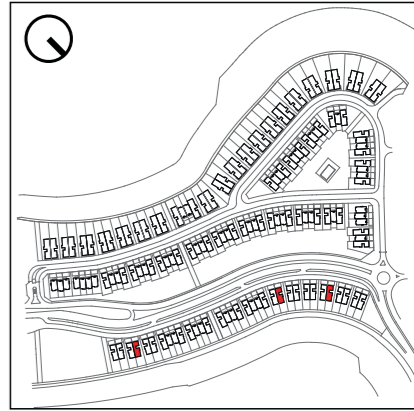

G. FLOOR

1. FLOOR

2. FLOOR

ROOF

4 BEDROOM (TYPE G)
+ FAMILY ROOM/ E

TOTAL AREA
445 sqm | 4,795 sqft



G. FLOOR

1. FLOOR

2. FLOOR

ROOF

4 BEDROOM (TYPE H)
+ FAMILY ROOM/ E

TOTAL AREA
453 sqm | 4,884 sqft



G. FLOOR

1. FLOOR

2. FLOOR

ROOF

5 BEDROOM (TYPE A)
+ FAMILY ROOM/ E

TOTAL AREA
633 sqm | 6,824 sqft



G. FLOOR

1. FLOOR

2. FLOOR

ROOF

5 BEDROOM (TYPE A1)
+ FAMILY ROOM/ E

TOTAL AREA
633 sqm | 6,824 sqft

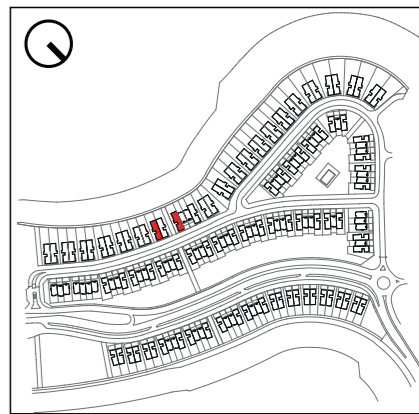



G. FLOOR



1. FLOOR



2. FLOOR



ROOF



5 BEDROOM (TYPE B)
+ FAMILY ROOM/ E

TOTAL AREA
633 sqm | 6,821 sqft



G. FLOOR



1. FLOOR



2. FLOOR



ROOF

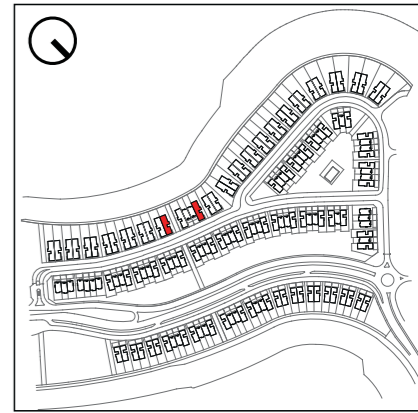

5 BEDROOM (TYPE B1)
+ FAMILY ROOM/ E

TOTAL AREA
633 sqm | 6,821 sqft



G. FLOOR



1. FLOOR



2. FLOOR



ROOF



5 BEDROOM (TYPE C)
+ FAMILY ROOM/ E

TOTAL AREA
633 sqm | 6,823 sqft



G. FLOOR



1. FLOOR



2. FLOOR



ROOF

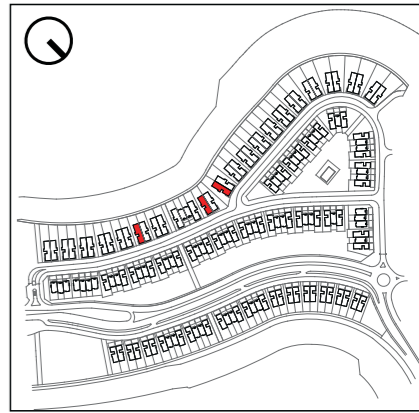

5 BEDROOM (TYPE C1)
+ FAMILY ROOM/ E

TOTAL AREA
633 sqm | 6,823 sqft



G. FLOOR



1. FLOOR



2. FLOOR



ROOF



5 BEDROOM (TYPE D)
+ FAMILY ROOM/ E

TOTAL AREA
636 sqm | 6,849 sqft



G. FLOOR



1. FLOOR



2. FLOOR

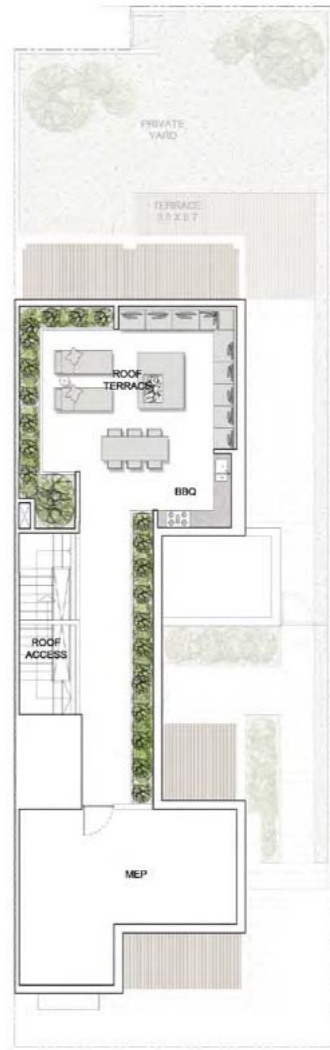

ROOF

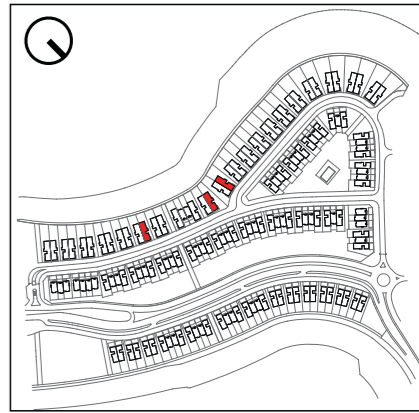

5 BEDROOM (TYPE D1)
+ FAMILY ROOM/ E

TOTAL AREA
636 sqm | 6,849 sqft